

How Do I Inspect and Service Air Cleaner? 10RESV/12RESV

INSPECTING AIR CLEANER

The engine is equipped with a replaceable, high-density paper air cleaner element. See Figure 4-7.

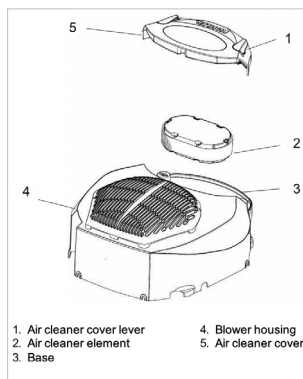

Figure 4-7

Check the air cleaner daily or before starting the engine. Check for buildup of dirt and debris around the air cleaner system. Keep this area clean. Also check for loose or damaged components. Replace all bent or damaged air cleaner components.

Note: Operating the engine with loose or damaged air cleaner components could allow unfiltered air into the engine causing premature wear and failure.

SERVICING AIR CLEANER

Replace the paper element at the intervals indicated in the service schedule. See Figure 4-7 for the air cleaner components.

- Press the off button on the generator set controller.
- Disconnect the utility power to the generator set.
- Disconnect the generator set engine starting battery, negative (-) lead first.
- Rotate the air cleaner cover levers outward to unlock cover; remove the air cleaner cover.
- Remove the paper element from the base.
- Do not wash the paper element or use pressurized air, as this will damage the element. Replace a dirty, bent, or damaged element. Handle new elements carefully; do not use if the sealing surfaces are bent or damaged.
- When servicing the air cleaner, check the air cleaner base. Make sure it is secured and not bent or damaged. Also, check the element cover for damage or improper fit. Replace all damaged air cleaner components.

Note: If any loose dirt or debris fell on the air cleaner base when the element was removed, carefully remove it and wipe the base clean. Be careful that none of it drops into the intake throat.

- Reinstall the paper element onto the air cleaner base. Make sure the element is flat and properly seated.
- Position the air cleaner cover with levers outward over air cleaner; turn levers inward to lock.
- When element replacement is necessary, order genuine KOHLER® parts.
- Reconnect the power to the battery charger.
- Reconnect the generator set engine starting battery, positive (+) lead first.