

How Do I Inspect and Service Air Cleaner? 14RCA

INSPECTING AIR CLEANER

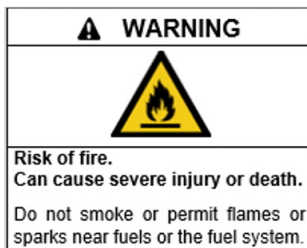

A sudden backfire can cause severe injury or death. Do not operate the generator set with the air cleaner removed.

The engine has a replaceable high-density paper air cleaner element. See Figure 4-8.

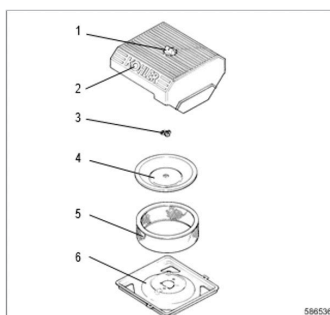

Figure 4-8

Check for buildup of dirt and debris around the air cleaner system. Keep this area clean. Also check for loose or damaged components. Replace all bent or damaged air cleaner components.

Note: Operating the engine with loose or damaged air cleaner components could allow unfiltered air into the engine causing, premature wear and failure.

Use the following procedure to replace the paper element at the intervals specified in the service schedule. Replace the paper element more often under extremely dusty or dirty conditions.

- Press the off button on the generator set controller.
- Disconnect the utility power to the generator set.
- Disconnect the generator set engine starting battery, negative (-) lead first.
- Loosen the cover retaining knob and remove the cover.
- Remove the element cover nut, element cover, and the paper element.

Note: Do not wash the paper element or clean it with pressurized air, as this will damage the element.

- Replace the element if it is dirty, bent, or damaged.
- Check the air cleaner base. Make sure it is secure and not bent or damaged. Also check the element cover for damage and fit. Replace all damaged air cleaner components. Remove any loose dirt or debris from the air cleaner base. Wipe the base carefully so that no dirt drops into the intake throat. Check the condition of the rubber seal on the air cleaner stud and replace the seal if necessary.
- Reinstall the paper element, element cover, element cover nut, and the air cleaner cover. Secure the cover with the cover retaining knob.
- Reconnect the utility power to the generator set.
- Reconnect the generator set engine starting battery, positive (+) lead first.