

# How Do I Inspect and Service Air Cleaner?

## 12RES

### INSPECTING AIR CLEANER

The engine has a replaceable high-density paper air cleaner element with an oiled foam precleaner. (See Figure 3-7.)

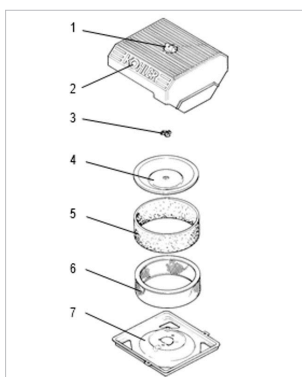

Figure 3-7

Check for buildup of dirt and debris around the air cleaner system. Keep this area clean. Also check for loose or damaged components. Replace all bent or damaged air cleaner components.

**Note:** Operating the engine with loose or damaged air cleaner components could allow unfiltered air into the engine, causing premature wear and failure.

### SERVICING PRECLEANER

Use the following procedure to wash and reoil the precleaner as indicated in the service schedule. Wash and reoil the precleaner more often under extremely dusty or dirty conditions.

- Place the generator set master switch in the off/reset position.
- Disconnect the power to the battery charger.
- Disconnect the battery, negative (-) lead first.
- Loosen the cover retaining knob and remove the cover. Remove the precleaner from the paper element. Wash the precleaner in warm water with detergent. Rinse the precleaner thoroughly until all traces of detergent are eliminated. Squeeze out excess water (do not wring). Allow the precleaner to air dry.
- Saturate the precleaner with new engine oil. Squeeze out all of the excess oil.
- Reinstall the precleaner over the paper element.
- Reinstall the air cleaner cover. Secure the cover with the cover retaining knob.
- Reconnect the power to the battery charger.
- Reconnect the generator set engine starting battery, positive (+) lead first.

### SERVICING PAPER ELEMENT

Use the following procedure to replace the paper element at the intervals specified in the service schedule. Replace the paper element more often under extremely dusty or dirty conditions.

- Place the generator set master switch in the off/reset position.
- Disconnect the power to the battery charger.
- Disconnect the generator set engine starting battery, negative (-) lead first.
- Loosen the cover retaining knob and remove the cover.
- Remove the element cover nut, element cover, and the paper element with precleaner.
- Remove the precleaner from the paper element.  
**Note:** Do not wash the paper element or clean it with pressurized air, as this will damage the element.
- Replace the element if it is dirty, bent, or damaged.
- Check the air cleaner base. Make sure it is secure and not bent or damaged. Also check the element cover for damage and fit. Replace all damaged air cleaner components. Remove any loose dirt or debris from the air cleaner base. Wipe the base carefully so that no dirt drops into the intake throat. Check the condition of the rubber seal on the air cleaner stud and replace the seal if necessary.
- Reinstall the paper element, precleaner, element cover, element cover nut, and the air cleaner cover. Secure the cover with the cover retaining knob.
- Reconnect the power to the battery charger.
- Reconnect the generator set engine starting battery, positive (+) lead first.